

# QCTHSA

## RETRACTABLE HEAVY DUTY QUARTER-TURN CLAMPS



**QCTHSA0834-20**  
(Plastic Knob)



**QCTHSA0834-20S**  
(Metal Knob)

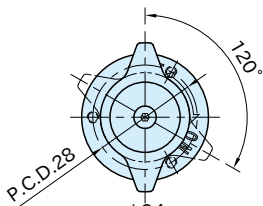

### ★Key Point

No interference by retractable shank

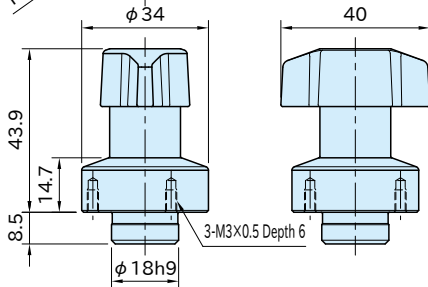

(OFF position)

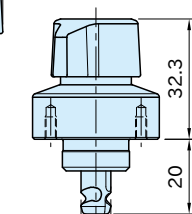

(ON position)

Part Number	Body	Shank	Pin	Knob	Spring A	Spring B
<b>QCTHSA0834-20</b>	SUS303 stainless steel	SKS3 steel Electroless nickel plated	SUS420J2 stainless steel Quenched and tempered	Polyamide (glass-fiber reinforced) Black	Equivalent to SWOSC-V steel	SUS304WPB stainless steel
<b>QCTHSA0834-20S</b>	steel	Quenched and tempered	Quenched and tempered	SCS13 stainless steel (Equivalent to SUS304)		

Part Number	Proper Plate Thickness	Clamping Force (N)	Weight (g)	Proper Locking Receptacle
<b>QCTHSA0834-20</b>	6~20	400	130	<b>QCTHS0834-B</b>
<b>QCTHSA0834-20S</b>			160	

### QCTHS-B LOCKING RECEPTACLE



### Supplied With

3 of socket-head cap screws (stainless steel)  
M3×0.5-10L

# QCTHSA

## SPACER



Stainless Steel

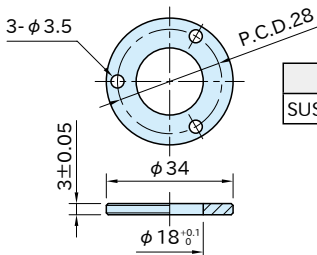

Body

SUS303 stainless steel

Part Number	Weight (g)
<b>QCTHSA34-03-SUS</b>	14

## Feature

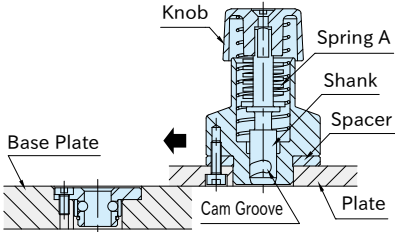

The shank retracts at the unclamping position to enable operations without interference with the base plate.

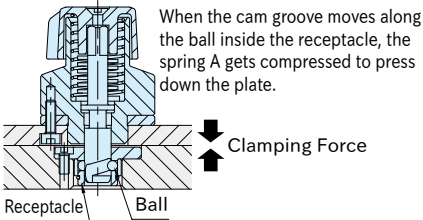

## Technical Information

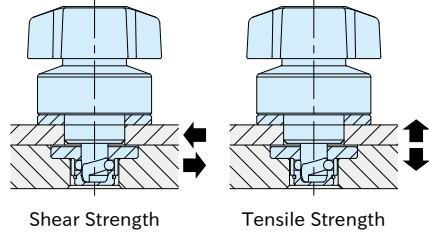

Part Number	Heatresistant Temperature (°C)	Shear Strength (N)	Tensile Strength (N)
<b>QCTHSA0834-20</b>	130	3000	1600
<b>QCTHSA0834-20S</b>	180	3000	1600

Shear and tensile strength is allowable load and the fastener breaks when it receives this load.

When the two plates receive tensile load that is bigger than the fastener's clamping force, there is a gap between the plates.

## How To Use

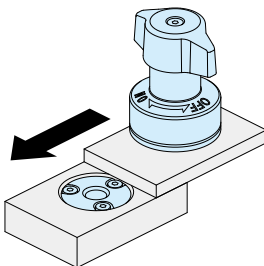

1. Ensure that the knob is positioned at the "OFF" mark.

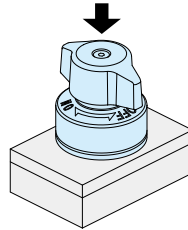

2. Insert the clamp pressing the knob.

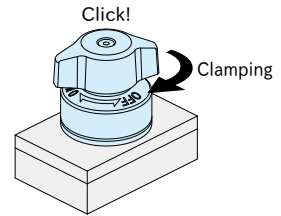

3. Turn the knob to the "ON" mark for clamping. The knob clicks when clamped. Turning the knob to the "OFF" position, the shank returns automatically to the unclamping position by the spring.

## Application Example

### Die Changing

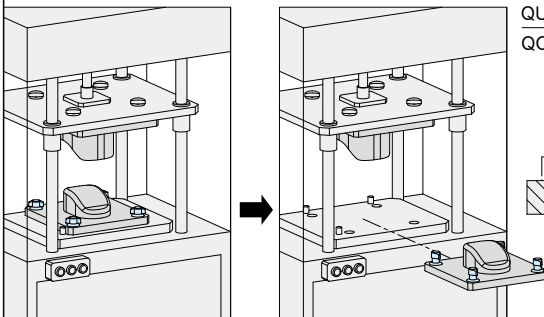

### RETRACTABLE HEAVY DUTY QUARTER-TURN CLAMP QCTHSA0834-20

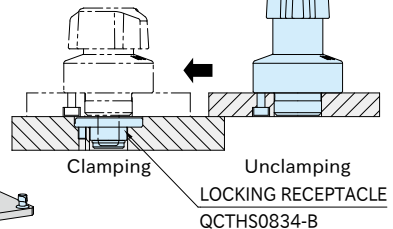

## Application Example

### Guide Changing

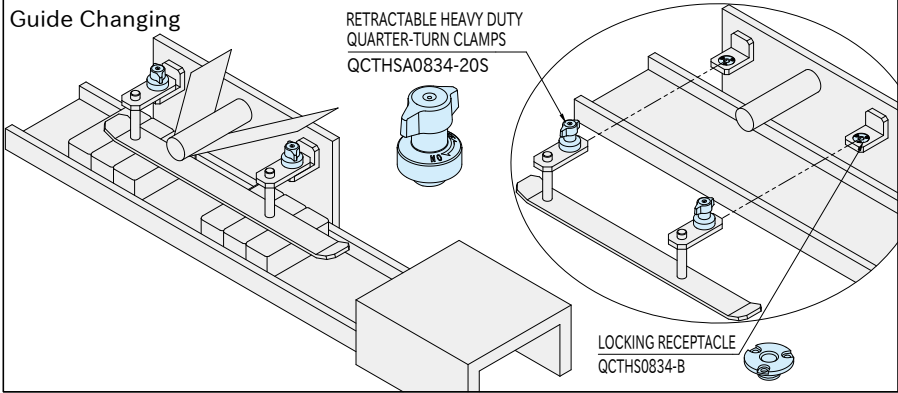

## How To Install

### For 9mm-thick plate

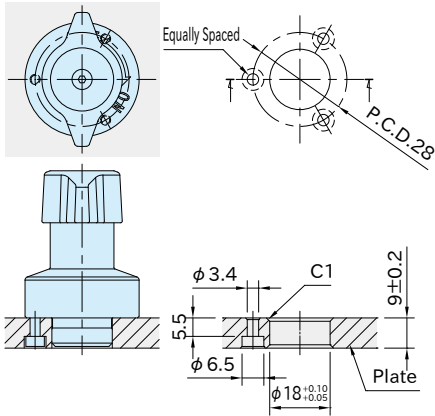

### For 9mm to 20mm-thick plate

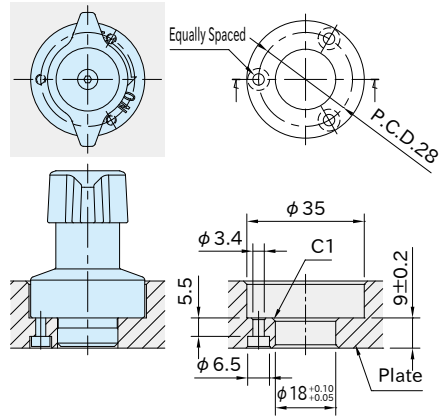

### ■ With Spacer

### For 6mm-thick plate

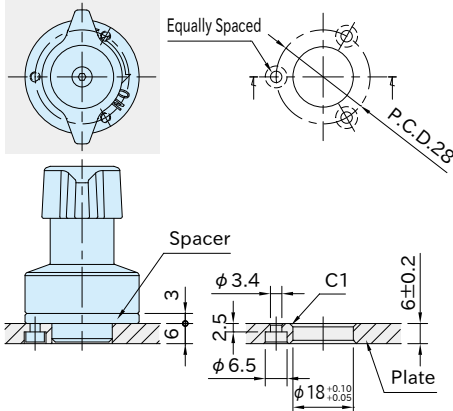

### For 6mm to 9mm-thick plate

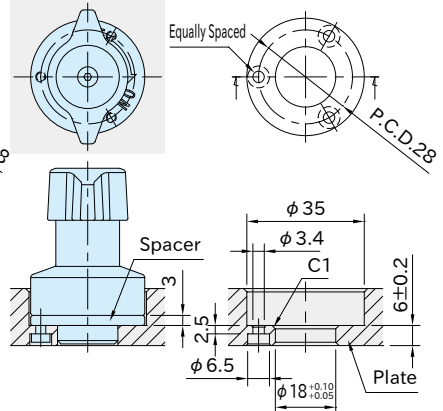

## Accuracy

### ■ Machining Accuracy

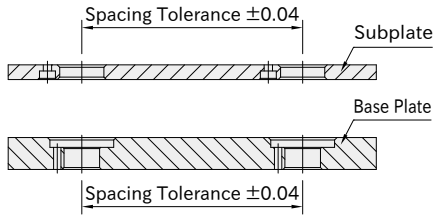

Spacing tolerance on both the subplate and the base plate should be  $\pm 0.04$ .

### ■ Repeatability

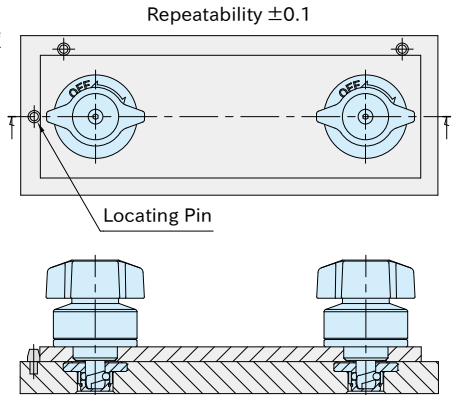

For higher accurate locating, use locating pins.

## Reference

"How To Install Receptacle" of [QCTHS-B](#) LOCKING RECEPTACLE.